



Whilst every effort is made to give a fair description, the accuracy of these particulars is not guaranteed, neither do they constitute an offer or contract.

MATHESONS ESTATE AGENTS have not tested any apparatus, equipment, fitting or services and so cannot verify that they are in working order. The buyer is advised to obtain verification from their solicitor or surveyor. Measurements are correct to within +/- 6 A sonic tape is used. None of the statements contained in these particulars or any of our properties are to be relied upon as a representation of fact.

166 Manor Park Road
Harlesden
London
NW10 4JT
T: 020 8965 2250
E: sales@mathesonsestates.com
www.mathesonsestates.com



Curtis Drive, London, W3 6YL

£325,000



KEY FEATURES:

- TWO BEDROOM
- THIRD FLOOR FLAT (TOP FLOOR)
- PURPOSE BUILT
- 10 MINUTES WALK TO TUBE
- PARKING
- RECEPTION 17 ft LEADS TO KITCHEN
- SHOWER ROOM
- ELECTRIC HEATING
- SECONDARY GLAZING

A TWO BEDROOM FLAT SITUATED ON THE THIRD FLOOR (TOP) OF A PURPOSE BUILT BLOCK. EXCELLENT OPPORTUNITY FOR A BUY TO LET OR FIRST TIME PURCHASE. The Flat has a 17 ft reception room leading to kitchen, 20 feet hallway, a shower room, electric heating, secondary glazing and allocated parking. Gross Internal Floor Area approx. 554 SQ FT (51 SQ M).

Curtis Drive is located on the increasingly popular Westcott Park Estate (off Cotton Avenue) which is located directly off the Western Avenue (A40) close to both North Acton Central Line, East Acton Central Line and Acton Main Line (soon to be Cross Rail) Stations.

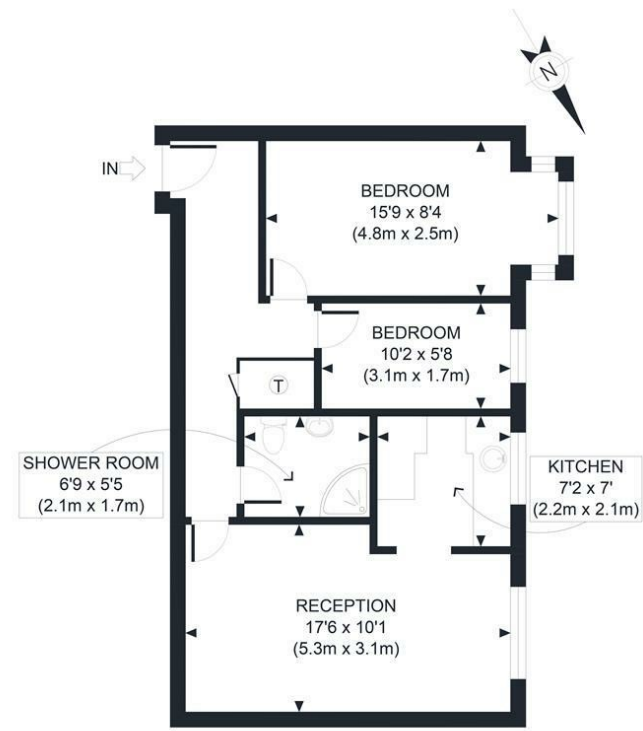

SECOND FLOOR
GROSS INTERNAL
FLOOR AREA 554 SQ FT

APPROX. GROSS INTERNAL FLOOR AREA 554 SQ FT / 51 SQM

Ref: Copyright **photoplan**

Disclaimer: Floor plan measurements are approximate and are for illustrative purposes only. While we do not doubt the floor plan accuracy and completeness, you or your advisors should conduct a careful, independent investigation of the property in respect of monetary valuation

